



ENGINEERING EXCELLENCE

## Installation Guide

**Two Handle Roman Tub Set:**

- 4DM610T
- 4DM710T

**This product meets the following standards:**

- ASME A112.18.1
- ANSI A117.1
- CUPC / IAPMO LISTED / ADA COMPLIANT

Thank you for purchasing this Pioneer quality product.

## Tools Required

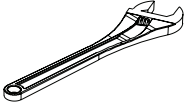

Adjustable-  
Wrench

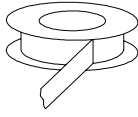

Sealant Tape

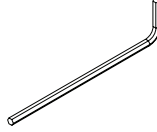

3/32" Allen  
Wrench

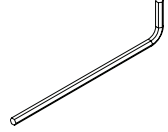

1/8" Allen  
Wrench

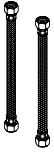

Flex Hose

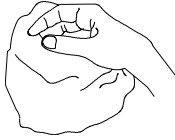

Rags

## Prior to Installation

- Observe all local plumbing and building codes before you begin installation.
- Carefully shut off both hot and cold main water supplies.
- Pioneer reserves the right to make changes in the design of faucets without notice as specified in the pricebook.

## Trim Installation

- Confirm the test plug (A) is threaded to the spout shank (B).
- Ensure the hot side valve and cold side valve are in fully closed position.
- Turn on the main water supply.
- Check for any leaks when the hot side and cold side valves are in closed and open position. Repair the leak if necessary.
- Close both side valves.
- Carefully remove the test plug turn on both side valves to drain any water then close both side valves.
- Reinstall the test plug to the spout shank and place the mudguards until trim is installed.

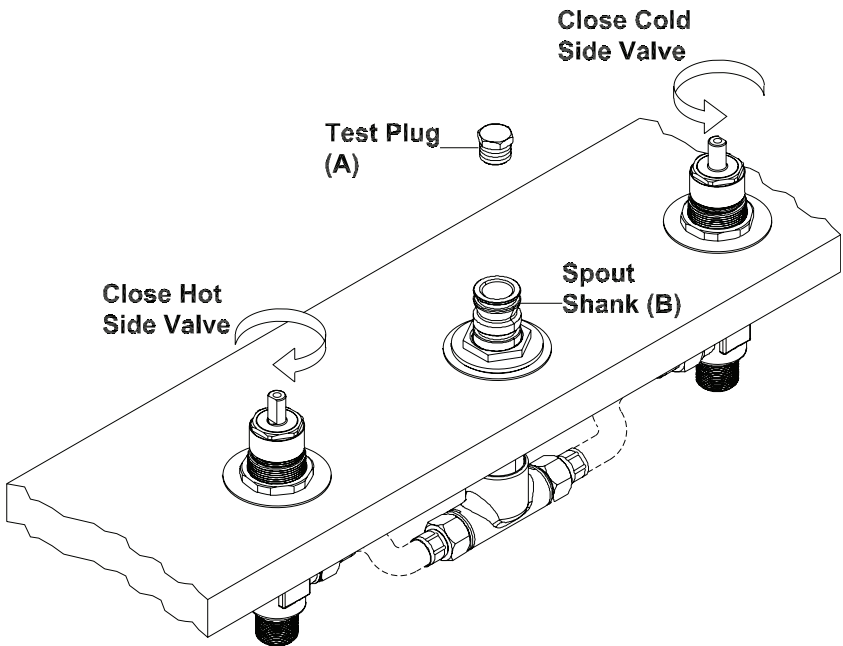

## Trim Installation

- Remove the mud guards from the spout shank and valves.
- Confirm the valve and spout dimension for 'X' & 'Z' where 'X' is the required valve height from the finished deck (C). And 'Z' is the shank height from the finished deck.

Series	'X'	'Z'
4DM610T	2"	1-1/2"
4DM710T	2"	1-11/16"

- Make necessary adjustment if necessary.
- Carefully remove the test plug (A) from the spout shank (B)

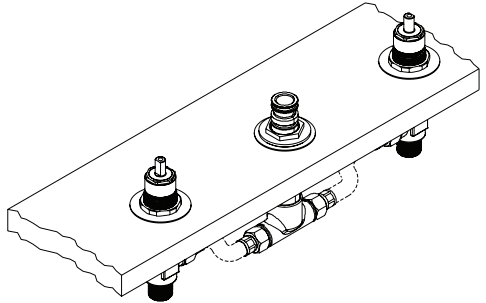
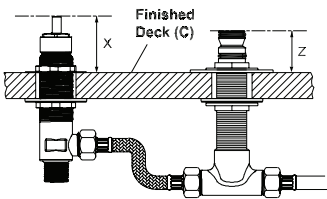

## Trim Installation

- Spout Installation: Place the spout escutcheon (E) with the gasket underneath. Carefully slide the spout (D) on the spout shank (B) so the O-ring on the spout shank does not get damaged.
- Tighten the 1/8" Allen screw (G) with the help of the Allen wrench tool provided. Do not overtighten.
- Place the button (F) to cover the hole.
- Handle & flange installation: Place the washer (K) underneath the handle flange (J). Thread the Handle Flange on the valve. Install the Handle facing in correct direction on the stem.
- Tighten the 3/32" Allen screw (I) with the help of the Allen wrench tool provided. Do not overtighten.
- Install the other side handles and flanges.
- Ensure the handles moves in correct direction.
- Turn on both side handles. Check for any leaks.

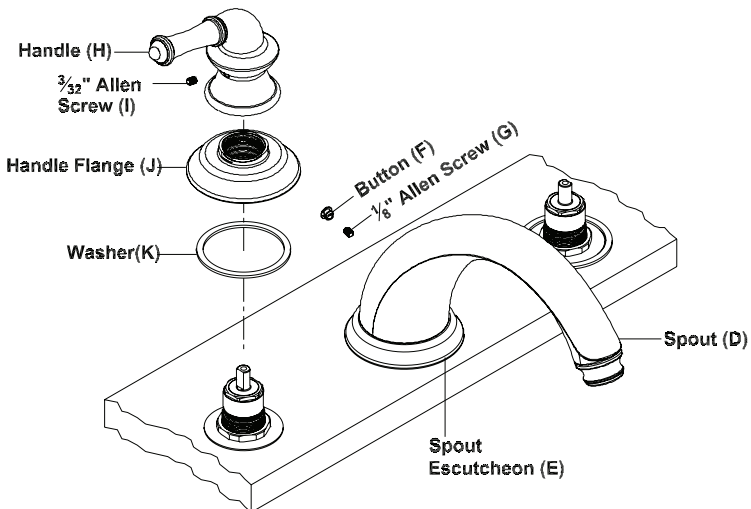



ENGINEERING EXCELLENCE

3325 S. Garfield Ave | City of Commerce, CA 90040  
Telephone: (800) 338-9468 | (323) 888-8873 | Fax: (323) 888-9515  
Hours: M - F, 7:30am to 5:00pm PST