



ENGINEERING EXCELLENCE

Del Mar Series #5DM100

PARTS BREAKDOWN SHEET

DESCRIPTION

- Two Handle Bar Faucet
- Del Mar Lever Handles
- Del Mar Series Gooseneck Spout
- 5-3/16" Reach, 5-7/8" From Deck to Aerator
- Ceramic Disc Cartridges
- 2 or 3-Hole 4" Installation

FINISHES

- PC PVD Polished Chrome
- BN PVD Brushed Nickel
- ORB Oil Rubbed Bronze

FLOW

- Aerator Limited to 2.0 gpm



#5DM100 SHOWN * ADA



STANDARDS APPLICABLE

- ASME A112.18.1
- ANSI A117.1
- ANSI / NSF 61, SECTION 9
- CUPC / IAPMO LISTED / ADA COMPLIANT
- CONTAINS NO MORE THAN 0.25% WEIGHTED AVERAGE LEAD CONTENT

Model #: _____

Specific Features: _____

Project Name: _____

Submitted For: _____

| Model | Description | Finishes | |
|---------|-----------------------|----------|----------|
| #5DM100 | Two Handle Bar Faucet | PC | Other___ |



ENGINEERING EXCELLENCE

Pioneer: 1-800-338-9468
 Commerce, CA 90040
 www.pioneerind.com
 Pioneer Industries, Inc. © 2009

DMPB5DM100/REV. 12 2009

Page 1 of 2

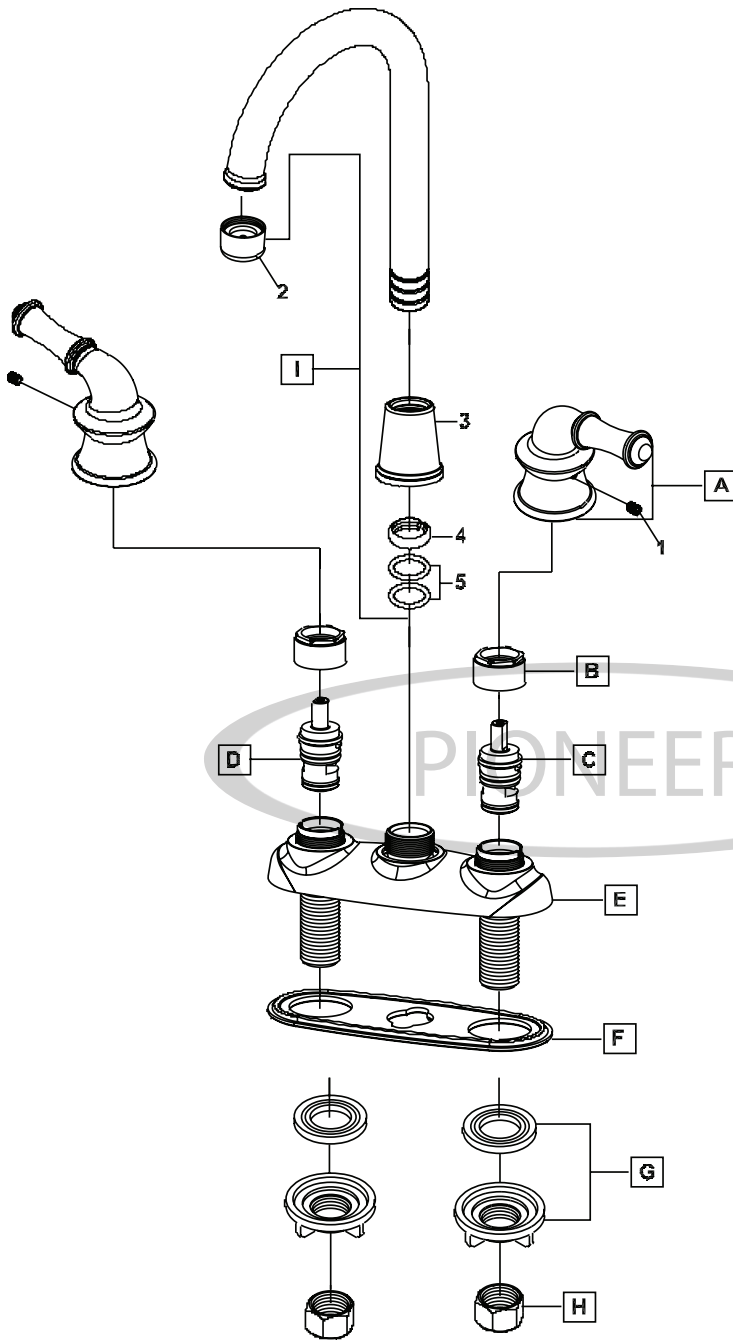

| | ITEM# | DESCRIPTION |
|---|------------|-------------------------------|
| A | X-1900005* | Del Mar Handle |
| B | X-4900007 | Bonnet Nut |
| C | X-3900002C | Ceramic Stem - Cold |
| D | X-3900002H | Ceramic Stem - Hot |
| E | X-4500002* | Deck Plate |
| F | X-4500003 | Base Plate |
| G | X-4900008 | Mounting Kit |
| H | X-4900004 | Supply Nut |
| I | X-2500001* | 5-3/16" Reach Gooseneck Spout |
| 1 | X-4900002 | Allen Screw |
| 2 | X-4900016* | 2.0 GPM Aerator |
| 3 | X-4500001* | Spout Sleeve |
| 4 | X-4900013 | Spout Snap Ring |
| 5 | X-4900012 | Spout O-ring |

* Note- Please specify finish/color code while ordering.

Product Diagram



ENGINEERING EXCELLENCE

Pioneer: 1-800-338-9468
 Commerce, CA 90040
 www.pioneerind.com
 Pioneer Industries, Inc. © 2009